

Red Emperor Fire Hose Reel Main Spindle With O-Rings and Circlips

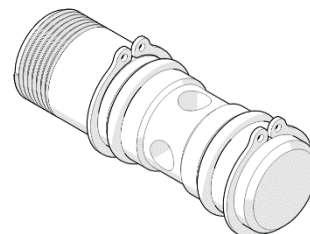

PRODUCT CODE:

- 383455

SPECIFICATIONS

- Brass construction
- Fitted with EPDM O-rings and steel circlips
- Fits as spare part of the main spindle for both Galvin Engineering Swing type (382523) and Fixed type (383026RE) fire hose reels.

WARNINGS: Special attention to be paid on notes, photos, images, or drawings of assembly steps marked with the warning symbol.



TECHNICAL DATA

Inlet	G 3/4" BSP
Outlet	N/A
Construction	Brass
Finish	Brass

NOTE: Galvin Engineering continually strive to improve their products. Specifications may change without notice.

DIMENSIONS

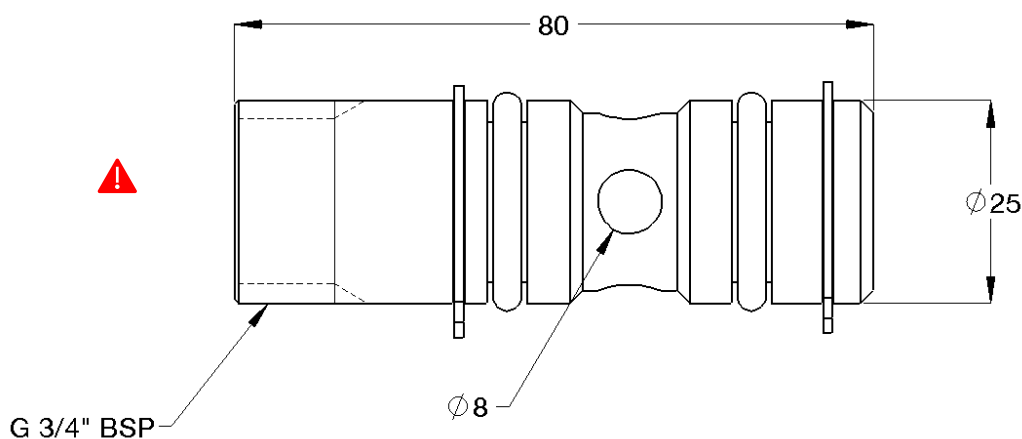

INSTALLATION

INSTALLATION COMPLIANCE: Galvin Engineering products must be installed in accordance with these installation instructions and in accordance with AS/NZS 3500, the PCA and your local regulatory requirements. Water and/or electrical supply conditions must also comply to the applicable national and/or state standards. Failing to comply with these provisions shall void the product warranty and may affect the performance of the product.

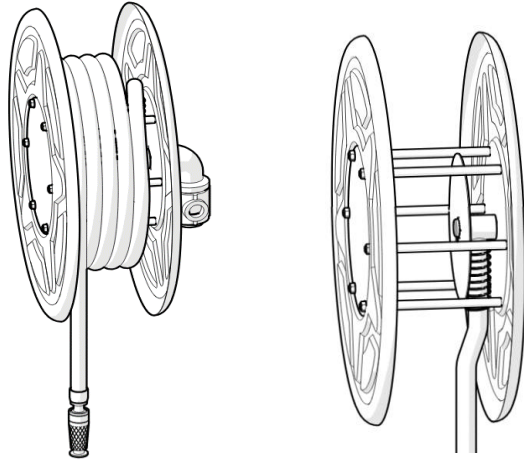

1. Remove hose

- Before conducting any maintenance activities, turn off mains water.
- Remove hose from reel

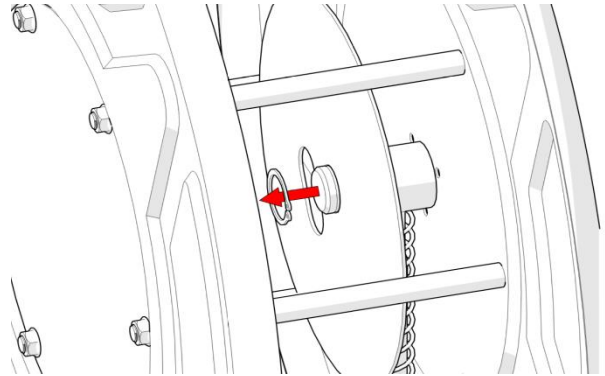

2. Remove circlip

- Locate and remove spindle circlip that holds the plate

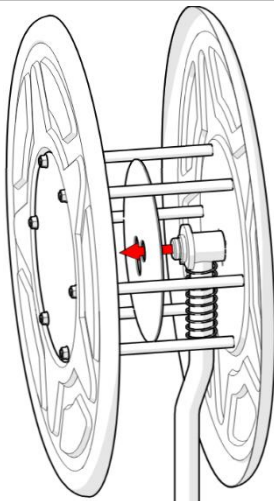

3. Detach plate

- Detach plate from spindle

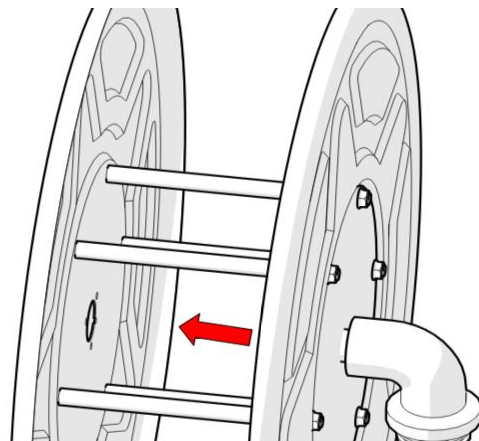

4. Pull reel away

- Pull reel away from connecting body (elbow or tee).

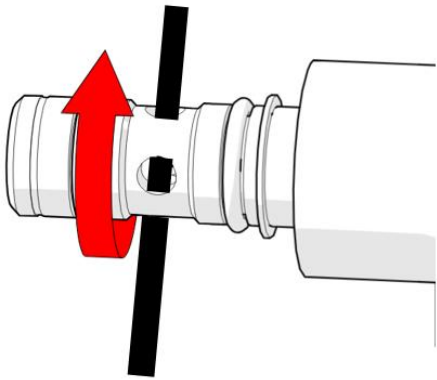

5. Remove old spindle

- Remove thread locking adhesive. It is recommended to use a blow torch (heat the area around the spindle connection up to 250°C) to melt the thread locking adhesive making it easier to unscrew.
- Insert a specialized tool (round bar, or any tool that will fit in the spindle hole) in the hole to act as a lever and aid in unscrewing the spindle.

⚠ Note: Spindle hole size is Ø8mm. Tool size to be inserted must be Ø7mm – Ø7.5mm to prevent damaging the internal part of the spindle when unscrewing.

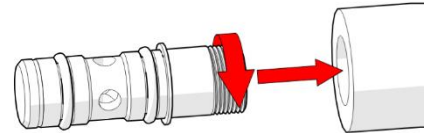
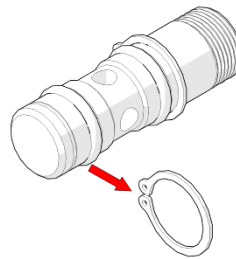

6. Insert new spindle

- Regrease new spindle before inserting it to the reel. We recommend using AS4020 approved grease Molykote 111.
- Remove the top spindle circlip, this it to be used later to lock the plate (see step 2) . Fit the new spindle to the connecting body (elbow or tee). Ensure thread locking adhesive is applied when screwing.
- Turn on mains supply and check for leaks around new spindle.

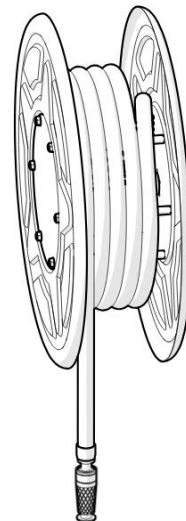
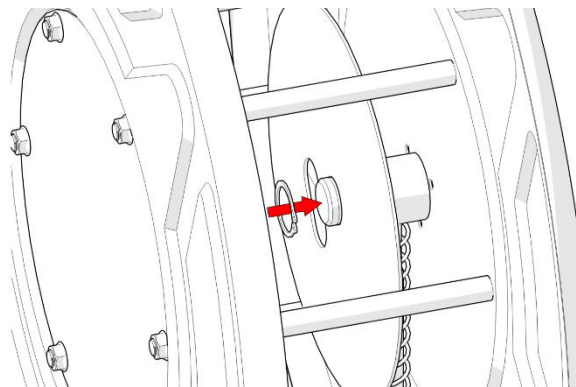

7. Reassemble

- Reassemble items by reversing steps 1 to 4.
- Ensure that during re-assembly, the top spindle circlip is reattached to the spindle to lock the plate.

WARRANTY

Galvin Engineering products are covered under our Manufacturer's Warranty. Galvin Engineering products must be installed in accordance with the installation instructions and in accordance with AS 3500 and NCC Volume Three, relevant Australian Standards and local authorities applicable to product being installed. Water and electrical supply conditions must also comply to the applicable national and/or state standards, failing to comply with these provisions may void the product warranty and affect performance of the product.

Please visit www.galvinengineering.com.au to view the full warranty, our Installation Compliance and Maintenance & Cleaning information as well as any other additional information.

Within Australia: 1300 514 074 Outside Australia: P: +61 (0)8 9338 2344

F: +61 (0)8 9338 2340

sales@galvinengineering.com.au

www.galvinengineering.com.au

ABN: 78 008 719 382

PERTH | SYDNEY | MELBOURNE | BRISBANE | ADELAIDE

